

Micro-Lock Plus 1.25mm-Pitch Wire-to-Board Connector System

molex[®]

Ideal for compact applications, the Micro-Lock Plus Wire-to-Board Connector System provides electrical and mechanical reliability in a high-temperature design that meets automotive and other industry requirements

Features and Benefits

Variety of connector colors

Aids assembly via color coding

Inner lock for dual-row versions; outer lock for single-row versions

Strengthens lock for more reliable connection

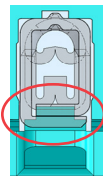
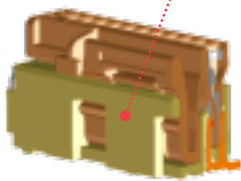

Expanded Terminal and Lance Contact Area

Smallest 1.25mm-pitch connector with positive lock

Delivers secure mating retention without sacrificing compactness

Wide positive latch that delivers audible click

Provides secure mating retention. Ensures proper mating

Dual contact terminal design

Offers secure contact and terminal retention

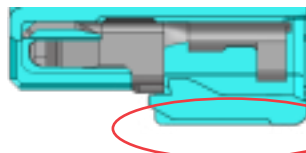

Increased Lance Thickness

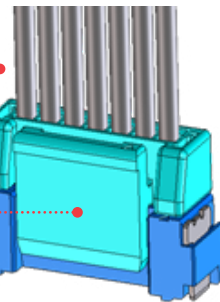

Tin-bismuth terminals Prevents whiskering for a clean and uninterrupted signal.

Supports terminal ruggedness and reliability

2 to 42 circuits, single and dual rows, vertical and horizontal plug configurations

Offers design flexibility

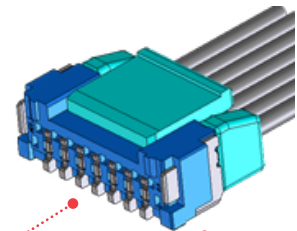

Withstands up to 105°C operating temperature

Meets automotive industry requirements. Withstands harsh environments

Robust metal solder tabs

Provides secure PCB retention and strain relief to solder joints

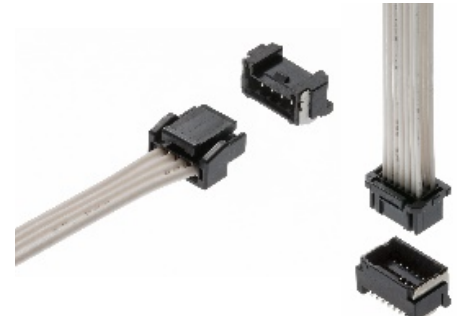

Micro-Lock 1.25mm-Pitch Wire-to-Board Connector System

Applications

Automotive

Steering wheel, paddle shift, combination switches
Shifters
Head-, rear-, side-mirror lights
Internal connection with other units

Industrial Automation

Consumer

White goods
Gaming machines
Drones
Air conditioners
Laser printers
Vacuum cleaners



White Goods



Steering Wheel Switches



Gaming Machines



Drones

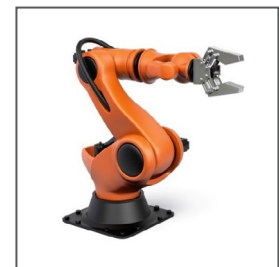

Industrial Automation

Micro-Lock Plus 1.25mm-Pitch Wire-to-Board Connector System



Specifications

REFERENCE INFORMATION

Packaging: Reel (Terminal); Embossed (Header Assembly); Bag (Receptacle Housing);
Mates With: Micro-Lock Plus Connectors
Use With:
Terminal Used:
Designed In: Millimeters
RoHS: Yes

ELECTRICAL

Voltage (max.): 50V
Current (max.): 1.5A
Contact Resistance on Crimped Portion (max.):
5 milliohms
Dielectric Withstanding Voltage: 500V AC
Insulation Resistance (min.): 100 Megohms

MECHANICAL

Crimp Terminal Insertion Force (max.): 4.9N
Crimp Terminal Retention to Housing (min.): 6.9N
Mating Force: 9.8N (2 Circuit)
Unmating Force: 0.3N (2 Circuit)
Durability (max.): 30 Cycles

PHYSICAL

Housing:
Receptacle — PBT
Header — PA9T
Contact: Copper Alloy
Plating (Receptacle):
Contact Area — Tin
Underplating — Nickel
Plating (Header):
Contact Area — Tin Bismuth
Nail Area — Tin over Nickel
Operating Temperature: -40 to +105°C

Ordering Information

Series No.	Pitch (mm)	Component	Circuits	Rows	Color
505431	-	Female Receptacle Terminal	-	-	-
505565	1.25	Receptacle Housing	2 to 16	Single	Black
505567		Right-Angle Header			
505568		Vertical Header			
505432		Dual-Row Receptacle Housing	8 to 42	Dual	Black
505433		Dual-Row Straight Plug			
505448		Dual-Row Right-Angle Plug			

www.molex.com/link/microlockplus.html

Molex is a registered trademark of Molex, LLC in the United States of America and may be registered in other countries; all other trademarks listed herein belong to their respective owners.